



Staff Report PC20-012-DP

CSL Plasma Building Expansion- Development Plan

Docket PC20-012-DP CSL Plasma Building Expansion - The petitioner is requesting approval of a Development Plan to be known as CSL Plasma Building Expansion. The subject property is currently zoned I-2 Industrial and is approximately 6.47 acres. This property is located at 3810 Perry Blvd, Whitestown. The petitioner is Becknell Industrial.



Proposed Development

The project site is currently zoned I-2, Industrial. The scope of the project is to construct an 70,900 square foot building expansion to the existing CSL Plasma building. This will include dock area. The project does not include extending utilities and roadways.

Below is the proposed plan:

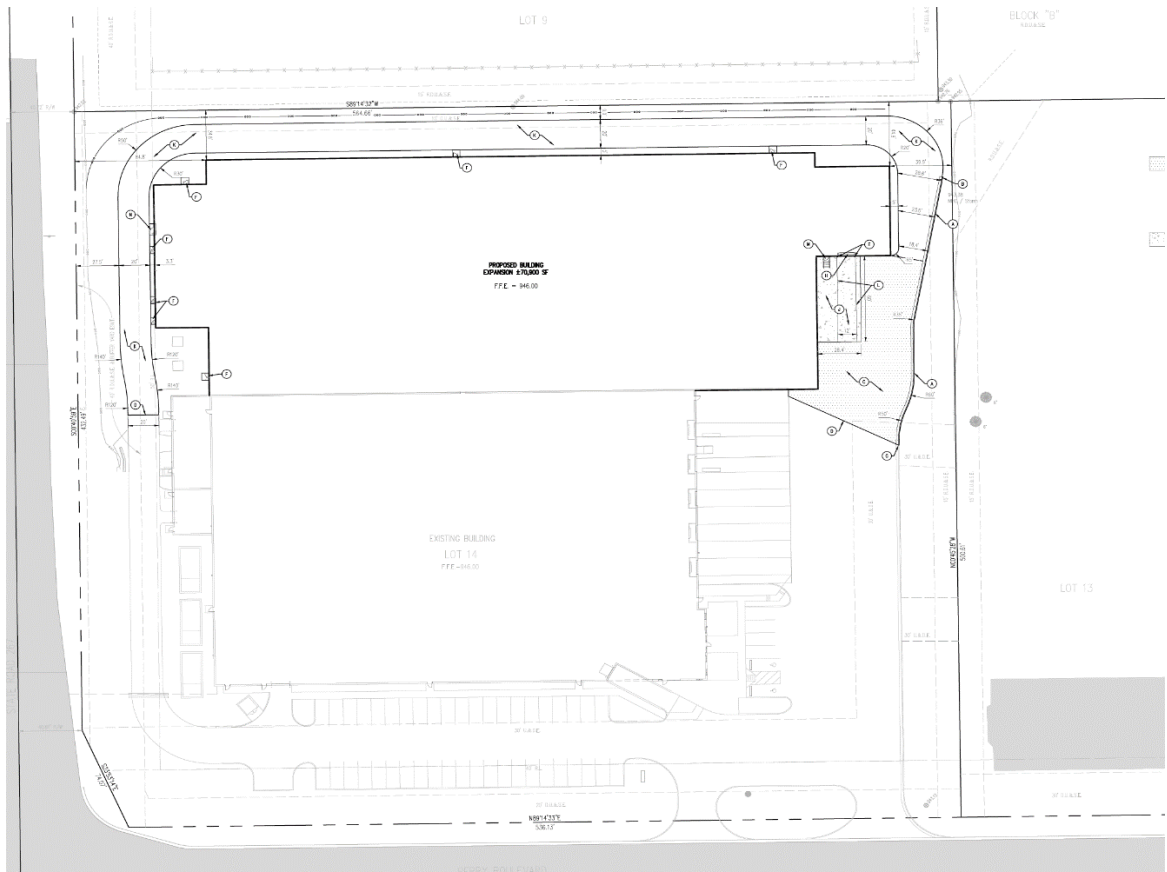

Compliance

The proposed concept plan, is in compliance with the standards of the Whitestown Unified Development Ordinance.

Staff Comments

Staff has checked the landscaping/buffering requirements, lighting standards, and overall compliance with the Whitestown Unified Development Ordinance.